

30 PINS 0.5 Pitch SMD Horizontal Type Bottom Contact Pedal-Lift ZIF Connector

Ver	Date	Description
1.0	Mar-04-2013	Preliminary Release

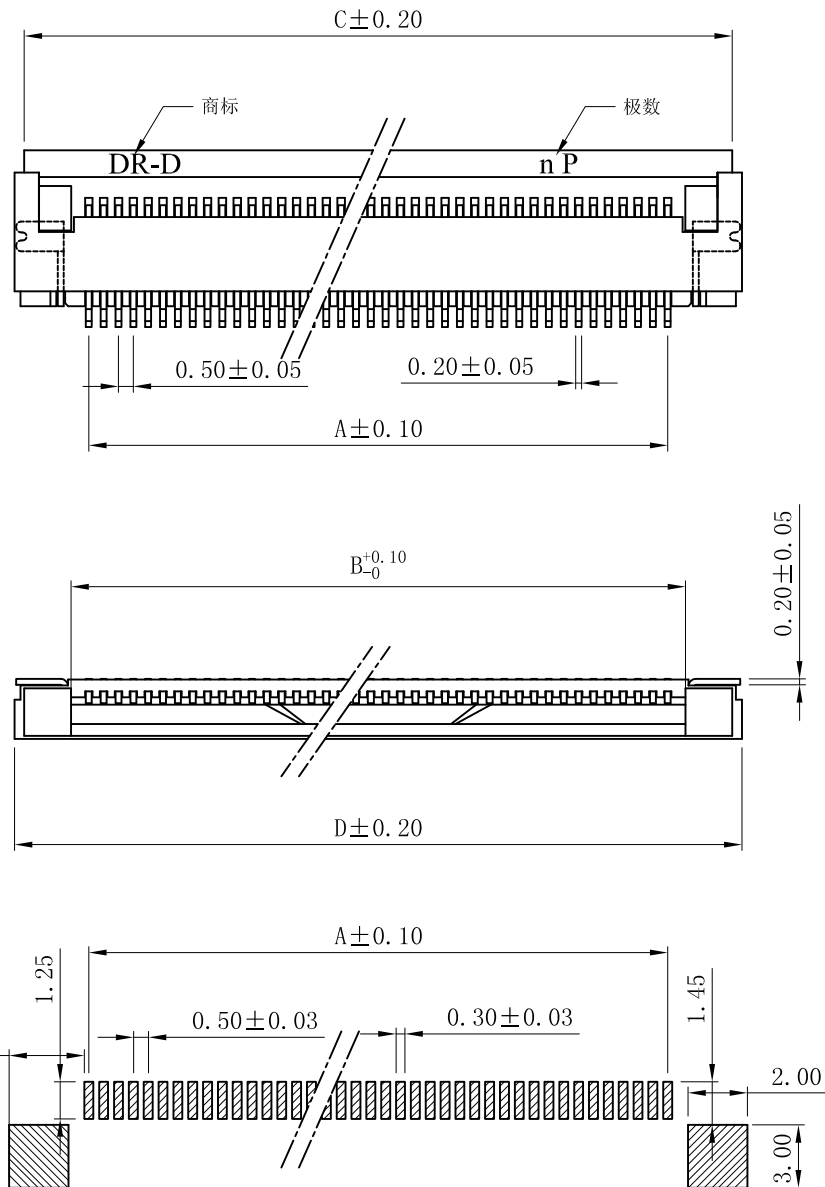

Pin Num	A	B	C	D
30	14.5	15.75	19.00	19.40

Material:

- 1、Housing: NYlon46 UL94V-0 Grey;
- 2、Loeker: PPS UL94V-0;
- 3、Contact: Phosphor bronze, tin/lead-plated;
- 4、Solder tab: Phosphor bronze, tin/lead-plated.

Specification:

- 2、Unverified Tolerance should comply with SJ1372-79;
- 3、Temperature Range: $-25^{\circ}\text{C} \sim 85^{\circ}\text{C}$;
- 4、Rated Voltage: 50V, AC, DC;
- 5、Contact Resistance: $\leq 0.03 \Omega$;
- 6、Insulation Resistance: $\geq 500\text{M} \Omega$;
- 7、Withstand Voltage: 500V, AC/minute.

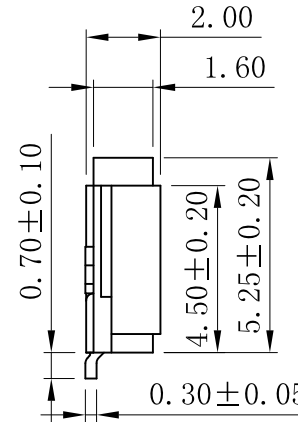

 旭日东方科技有限公司 EastRising Technology Co., Ltd. <small>buy-display.com TEL: +86-755-33503873 FAX: +86-755-33507642-801</small>		CD
	UNIT: MM	SIZE: A4
SHEET: 1 OF 1		
Part Number for Order: ER-CON30HBPL-1		
DRAWN BY : Jim	CHECKED BY Tony	APPROVED BY Liu